

C100



Junior pipe clamp with 28 mm socket

Clamping range encompasses pipe from 20 mm to 55 mm diameter.



material: rugged gravity cast aluminium



finish: black powder smooth RAL 9005



weight: 1,13 kg
2,49 lb



volume: 0,005 cu m
0,177 cu ft



max. load: 250 kg
550 lb



weight: 1,18 kg
2,601 lb

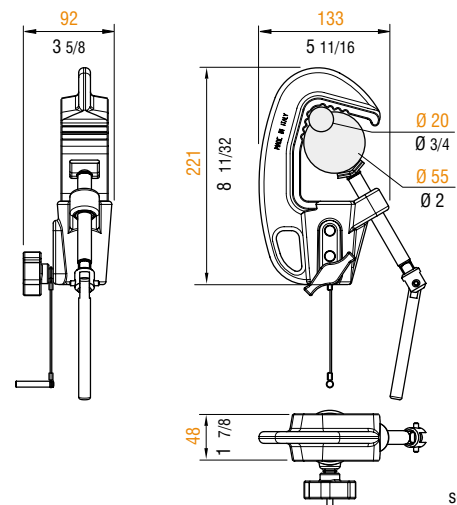
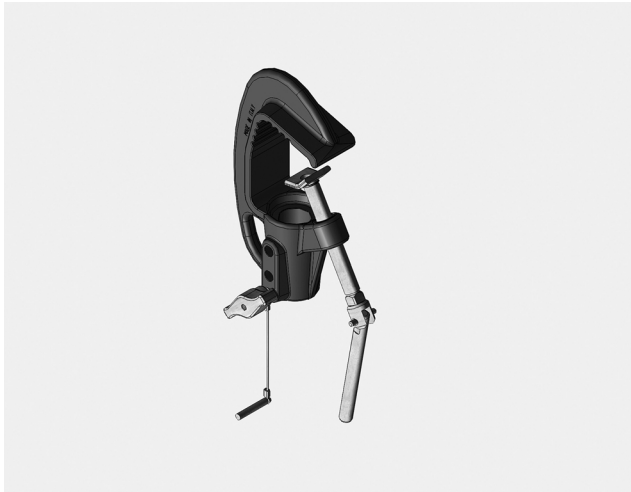

scale 1:7,5

APPLICATIONS

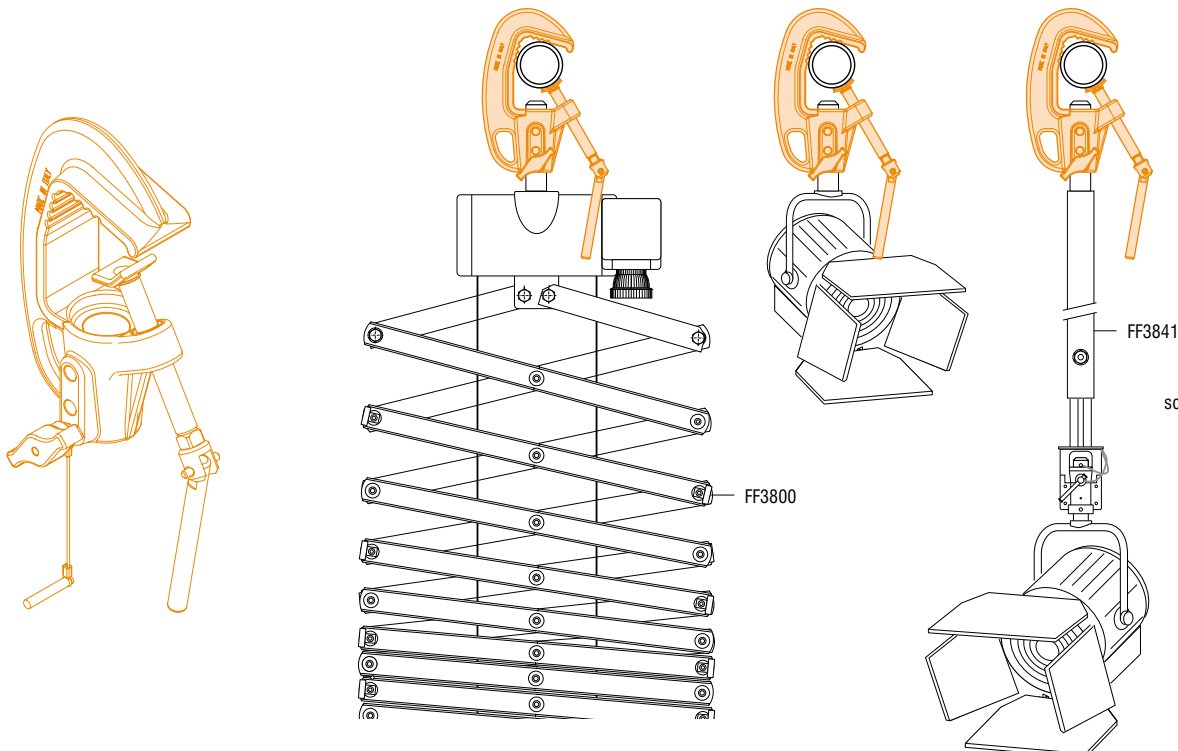

scale 1:10

Metric measurements should be taken as reference. Imperial values have been calculated from metric and rounded to nearest 1/32 inch.
IMPORTANT: installation must be carried out by qualified personnel and in accordance with the safety regulations of the country/region of installation.