

Rails 60 curved 90°

- FF60R105: radius 1050mm – 41 11/32"
- FF60R120: radius 1200mm – 47 1/4"
- FF60R135: radius 1350mm – 53 5/32"
- FF60R150: radius 1500mm – 59 1/16"
- FF60R165: radius 1650mm – 64 31/32"
- FF60R180: radius 1800mm – 70 7/8"



material: aluminium



finish: silver

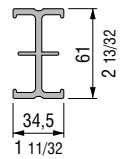
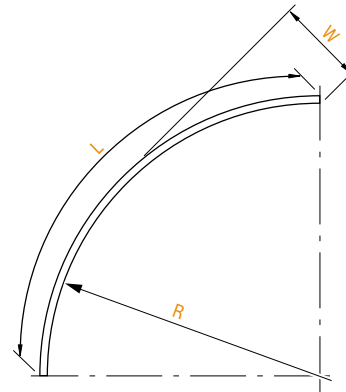

1

	FF60R105	FF60R120	FF60R135	FF60R150	FF60R165	FF60R180
R radius:	mm 1050	1200	1350	1500	1650	1800
	inch 41 11/32	47 1/4	53 5/32	59 1/16	64 31/32	70 7/8
L length:	mm 1650	1885	2121	2357	2542	2828
	inch 5 - 4 31/32	6 - 2 7/32	6 - 11 1/2	7 - 8 25/32	8 - 4 3/32	9 - 3 11/32
W width:	mm 307	351	395	439	483	527
	inch 12 1/8	13 3/4	15 1/2	17 1/4	19	20
weight:	kg 2,24	2,56	2,88	3,2	3,52	3,85
	lb 5	5,7	6,4	7	7,8	8,5
volume:	cu m 0,027	0,036	0,046	0,057	0,069	0,08
	cu ft 0,953	1,271	1,624	2,01	2,43	2,82
weight:	kg 2,24	2,56	2,88	3,2	3,52	3,85
	lb 5	5,7	6,4	7	7,8	8,5

Metric measurements should be taken as reference. Imperial values have been calculated from metric and rounded to nearest 1/32 inch.
IMPORTANT: installation must be carried out by qualified personnel and in accordance with the safety regulations of the country/region of installation.

Rails 60 curved 90°

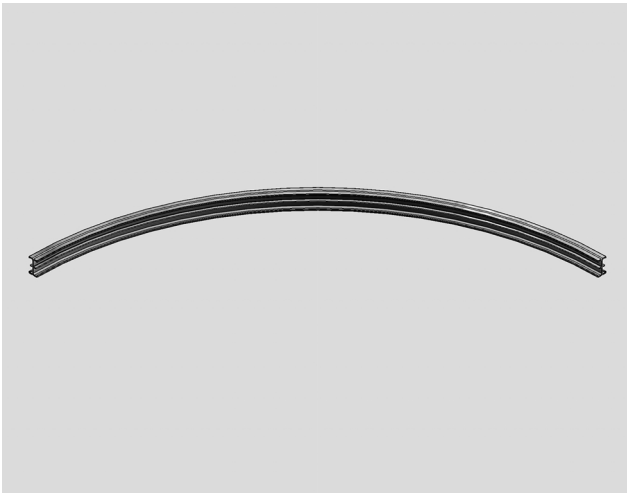

Curved rails are in several standard radius available (see page 14).

APPLICATIONS

circular cyclorama
scale 1:100

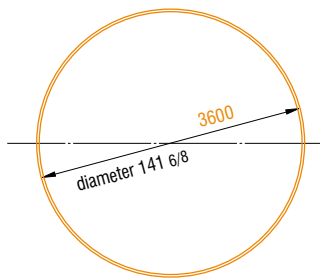

semicircular cyclorama
scale 1:100

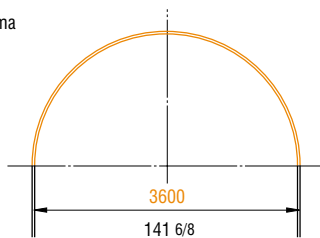

standard cyclorama
scale 1:100

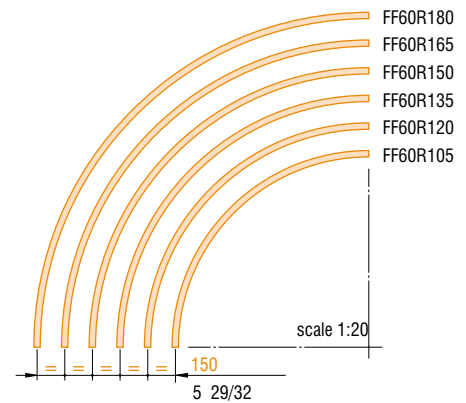
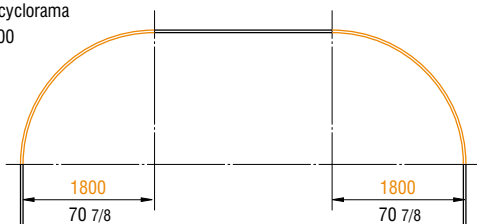

EXAMPLE WITH 3 CYCLORAMA RAILS

Curved rails require at least one additional hanging point in the middle of the rail.
scale 1:20

